

SafeCase

CRBN™

User Manual for iPhone 15

April 23, 2026



---

## TABLE OF CONTENTS

---

<b>Section 1: SafeCase CRBN for iPhone 15</b>	1
Before you begin	1
Parts	1
<b>Section 2: Prepare your phone and SafeCase</b>	2
Step 1: Prepare Your iPhone	2
Step 2: Insert iPhone into CRBN	2
To Remove iPhone from SafeCase CRBN	2
Step 3: Power On and Charge	2
Step 4: Install, Open and Configure the Privoro App	3
Step 5: Accept Terms	3
Step 6: Grant Required Permissions	3
Step 7: Start Using SafeCase	3
<b>Section 3: Checking SafeCase CRBN Status in the Privoro App</b>	4
<b>Section 4: Managing SafeCase Modes</b>	5
Outside Secure Spaces — Assurance Modes	5
Audio Passthrough (Context-Dependent)	5
Inside Secure Spaces — Policy Mode	6
<b>Section 5: Using SafeCase in a Restricted Area (Enterprise Use)</b>	7
Step 1: Verify Compliance	7
Option A: Quick Compliance Check (Recommended)	7
Option B: Full Compliance Check (In App)	7
Step 2: Check Into Secure Mode	7
Manual Check In	8
Step 3: Exit a Restricted Area	8
<b>Section 6: SafeCase and Phone Linking</b>	9
<u>Appendix A: Enable SafeCase Edge Locking Shortcut in The Privoro App</u>	10
<u>Appendix B: Creating a Check-in Automation in iOS Shortcuts (Cellular Data Off)</u>	11
<u>Appendix C: Creating a Check-in Automation in iOS Shortcuts (Airplane Mode)</u>	14
<u>Appendix D: Daily Charging Requirements and Approved Accessories</u>	16
Managing Power	16
Check Battery Level	16
Approved Charging Accessories	16
<u>Appendix E: Verifying Audio Masking</u>	17
<u>Appendix F: Safety and Handling</u>	18
<u>Appendix G: Recycling</u>	18

---

## TABLE OF CONTENTS

---

<u>Appendix H: Regulatory Information</u> .....	19
FCC Compliance Statement .....	19
Canadian Regulatory Statement .....	19
Specific Absorption Rate (SAR) Certification Information .....	19
EU Compliance Statement .....	19
European Union–Disposal Information .....	19

## SafeCase CRBN User Manual for iPhone 15

This guide walks you through initial SafeCase setup, daily operational use, and the steps required to securely pair SafeCase with its designated iPhone.

### Before you begin

Make sure you have:

- A SafeCase CRBN
- An iPhone 15
- Two USB-C charging cables (included)
- (one comes with your iPhone, the other from Privoro)
- Two USB-C power adapters (20W recommended), provisioned by your support team

Familiarize yourself with the SafeCase part names and their functions.

### Parts

CRBN consists of the following parts:

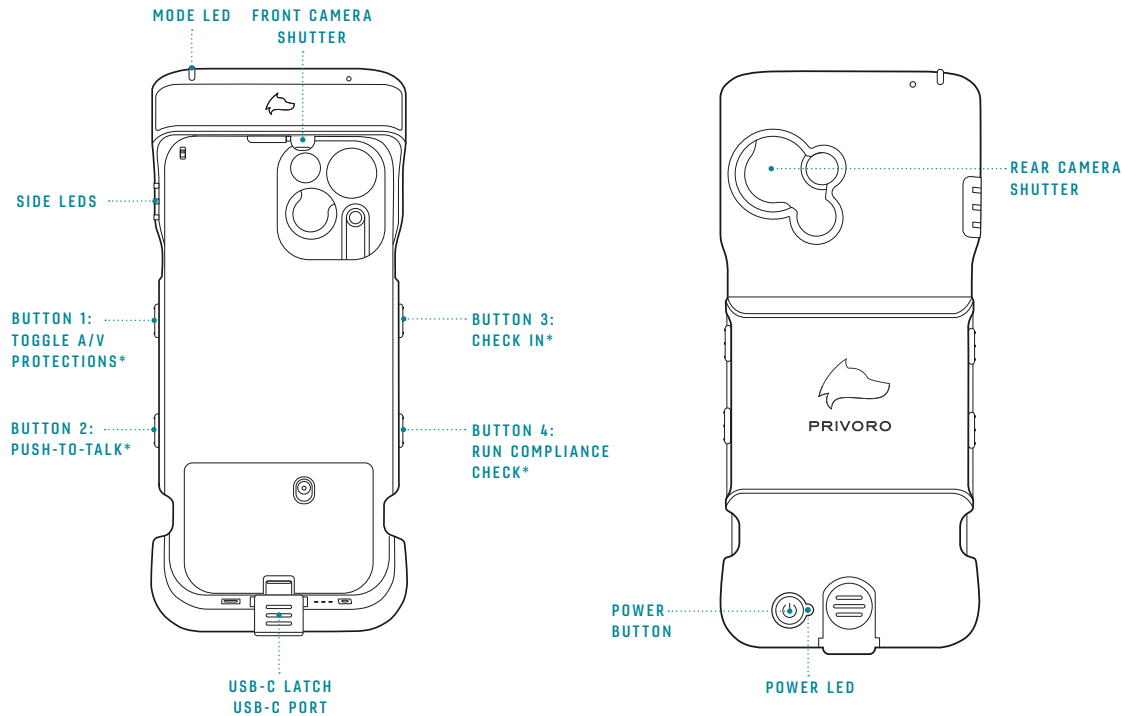

## Prepare your phone and SafeCase

### Step 1: Prepare Your iPhone

1. Remove any screen protectors or privacy screens
2. Open **Settings/Bluetooth**
3. Turn On

### Step 2: Insert iPhone into SafeCase CRBN

1. Pinch and pull the USB-C latch away from the case
2. Slide the iPhone head-first under the front camera shutter
3. Lower the phone into the case base until fully seated
4. Push the USB-C latch back into the case to lock the phone

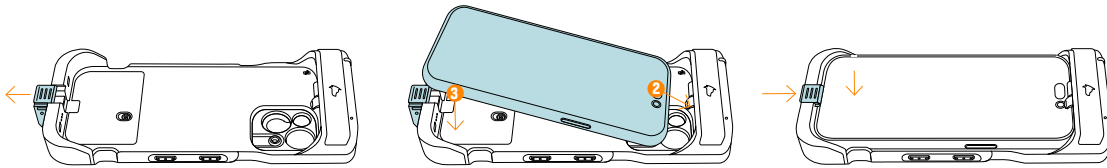

### To Remove iPhone from SafeCase CRBN

1. Pinch and pull the USB-C latch away from the case
2. Pull the bottom of the iPhone off the base and slowly remove

### Removing iPhone Outside Campus Boundaries

The iPhone may be removed from SafeCase only after exiting the physical boundaries of the campus or approved facility, in accordance with organizational policy.

While anywhere within campus or facility boundaries, including pass-through or limited areas, the iPhone must remain installed in SafeCase.

### Step 3: Power On and Charge

1. Connect the USB-C cable to the SafeCase
2. Plug the other end into a powered USB-C adapter
3. What you should see:
  - Power and Mode LEDs blink white five times
  - Camera shutters close automatically

This indicates SafeCase is powered on and protections are active

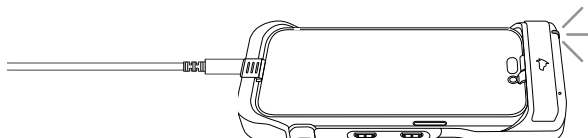

## Step 4: Install, Open and Configure the Privoro App

1. Open the **Apple App Store**
2. Search for **Privoro**
3. **Tap Get**, then **Open**

## Step 5: Accept Terms

On the Get Started screen, review the:

- End User License Agreement
- Terms and Conditions
- Privacy Policy

**Tap Agree & Continue**

## Step 6: Grant Required Permissions

On the **Permissions Required** screen, tap continue. All permissions are contained in an in-app tutorial. When prompted within the tutorial, grant the following permissions:

- **Camera** – Grant Permission
- **Microphone** – Grant Permission
- **Notifications** – Grant Permission
- **Bluetooth** – Grant Permission
- **Motion** – Grant Permission
- **Location** – Allow While Using App
- **Local Network** – Grant Permission

Tap Continue after all permissions are granted

## Step 7: Start Using SafeCase

1. On the **Ready to Start Using Your SafeCase** screen, tap **Start Using SafeCase**
2. When prompted, allow the app to find devices on the local network

## Checking SafeCase CRBN Status in the Privoro App

On the **My SafeCase** screen, confirm:

- **Cloud Monitoring** shows **Connected**
- **Secure WiFi Connection** is showing
- **Secure Mode** status is visible
- **SafeCase Battery Level** is displayed

This completes the setup steps.

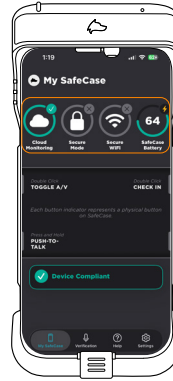

## Managing SafeCase Modes

SafeCase operates in three distinct modes. The active mode controls camera, microphone, and radio behavior and is indicated by the Mode LED.

**Important:** When SafeCase is in Secure Mode (checked in to a secure space), user controls are locked. Mode changes, Audio Passthrough, and LED brightness adjustments are disabled.

### SafeCase Base Operating Modes – At a Glance

Mode	Primary Use	Cameras	Microphones	Policy Enforced	Cellular	Bluetooth	Mode LED
<b>Protected Mode (Default)</b>	Everyday assurance use	Blocked	Masked	No	On	On	Green
<b>Unprotected Mode</b>	Full device functionality	Exposed	Exposed	No	On	On	Red
<b>Secure Mode</b>	Enforced policy in secure spaces	Blocked	Masked	Yes	Off	On	Blue

### Audio Passthrough (Context-Dependent)

Context	Base Mode	What Changes	LED Behavior	When PTT Released
Outside secure space	Protected (Green)	Microphones temporarily exposed; cameras remain blocked	Red while active	Returns to Green

Audio Passthrough does not exit Protected Mode. It temporarily relaxes microphone protections and returns to the active base mode when released.

### Mode Controls

These controls function only when not in Secure Mode.

#### Toggle Protected/Unprotected Mode

**Action:** Double-click the top left-hand button

**Confirm:**

- Green LED = Protected
- Red LED = Unprotected  
LED pulses every 10 seconds to indicate active mode.

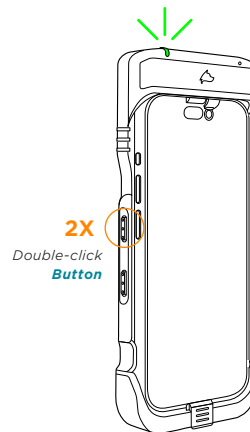



### Audio Passthrough (Push-to-Talk)

Temporarily exposes microphones while the button is pressed.

**Action:** Press and hold lower left-hand button

**While Held:** LED blinks Red

**Release:** Returns to Protected Mode (Green)

Audio Passthrough:

- Does not change modes
- Does not expose cameras
- Is disabled in Secure Mode

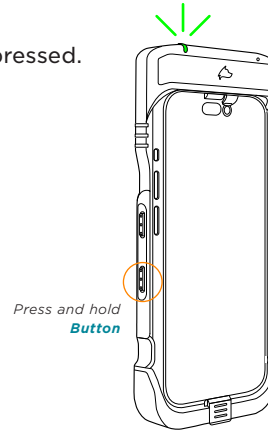

### Adjust LED Brightness (Optional)

1. Double-click Power button
2. Press to cycle: High, Low, Off
3. Selection confirms automatically

LED brightness cannot be changed while in Secure Mode.

### Secure Mode (Checked-In State)

When checked into a secure space:

- Policy is enforced
- Cellular is disabled
- Cameras remain blocked
- Microphones remain masked
- Mode changes are disabled
- Audio Passthrough is disabled
- LED brightness adjustment is disabled

Secure Mode is designed to prevent accidental changes and ensure compliance inside controlled environments.

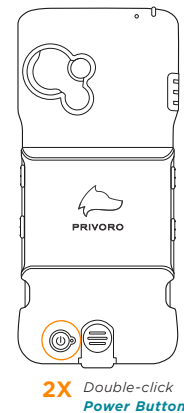

## Using SafeCase in a Restricted Area (Enterprise Use)

This section covers only the steps required to enter, remain compliant within, and exit a restricted area using SafeCase CRBN.

### Before You Enter a Restricted Area

#### Step 1: Verify Compliance

You can verify compliance in one of two ways.

##### Option A: Quick Compliance Check (Recommended)

1. Press and hold the upper right-hand button for 2 seconds.
2. Check the Side LED color:
  - **Green** = Ready to enter restricted area
  - **Amber** = Attention required; run a full compliance check
  - **Red** = Not compliant; run a full compliance check

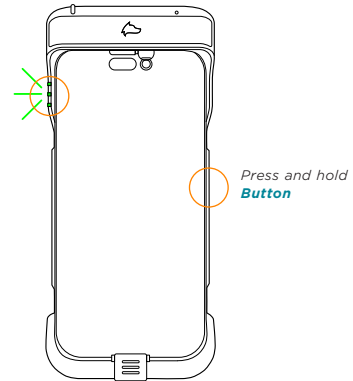

##### Option B: Full Compliance Check (In App)

1. Open the Privoro app.
2. On the My SafeCase screen, double-click the lower right-hand button – **Run Compliance Check**.
3. Follow any on-screen instructions.
4. Continue until the app shows **Device Compliant**.



#### Step 2: Check Into Secure Mode

You may Check-In automatically or manually, depending on your site configuration.

##### Automatic Check In (Wi Fi Based)

1. Approach the restricted area.
2. When your iPhone joins the approved Wi Fi network:
  - SafeCase checks in automatically
  - A Secure Mode audio alert plays
  - The Mode LED pulses Blue

## Manual Check-In & Check-Out

### Before Check-In

Before manually checking into Secure Mode, disable cellular connectivity in accordance with your organization's policy.

Your organization may require one of the following:

- **Turn Cellular Data Off**, or
- **Enable Airplane Mode**

Once cellular connectivity is disabled, proceed to check in.

### Check In to Secure Mode

1. Double-click the upper-right-hand button
2. Confirm the Mode LED:
  - Blinks Blue five times
  - Pulses Blue every 10 seconds
3. Enter the restricted area.

## While Inside a Restricted Area

### Policy Enforcement

SafeCase enforces policy automatically.

If a required condition is not met, you will receive an alert via:

- App notification
- LED indication
- Audio prompt

Failure to remediate may result in the phone being locked.

### Wired Headset Use (If Approved)

Unclassified calls may be conducted using an organization-approved wired headset.

- Do not conduct calls within one meter of classified computing equipment.
- When not in use, disconnect or disable the headset in accordance with policy.

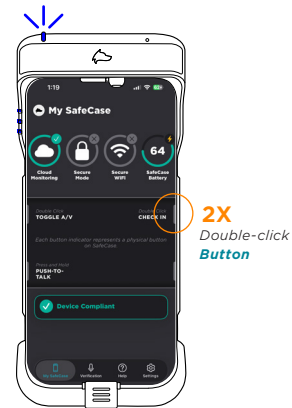

## Check Out of Secure Mode

1. Exit the restricted area.
2. Wait until the phone disconnects from the approved Secure Wi-Fi network.
3. When prompted by audio alert, double-click the upper-right-hand button.
4. Confirm the Mode LED:
  - Blinks Green five times
  - Pulses Green every 10 seconds
5. Restore connectivity according to your organization's policy:
  - Turn On Cellular Data Primary, or
  - Disable Airplane Mode

## SafeCase and Phone Linking

SafeCase Phone Linking ensures that each SafeCase is associated with its designated iPhone. This prevents unauthorized device use and enables organizational monitoring and policy enforcement.

Phone Linking is typically completed during onboarding or device re-issuance and is coordinated with your organization's management portal.

### Phone Linking to SafeCase:

1. Open the **Privoro App** and navigate to the **Settings** screen
2. Select **SafeCase Link**
3. The app will display the status: **SafeCase Unlinked**
4. Tap **Link SafeCase** and confirm by tapping Link
5. The app will display **SafeCase Linked**

NOTE: Unlinking can only be performed by your system administrator or support team.

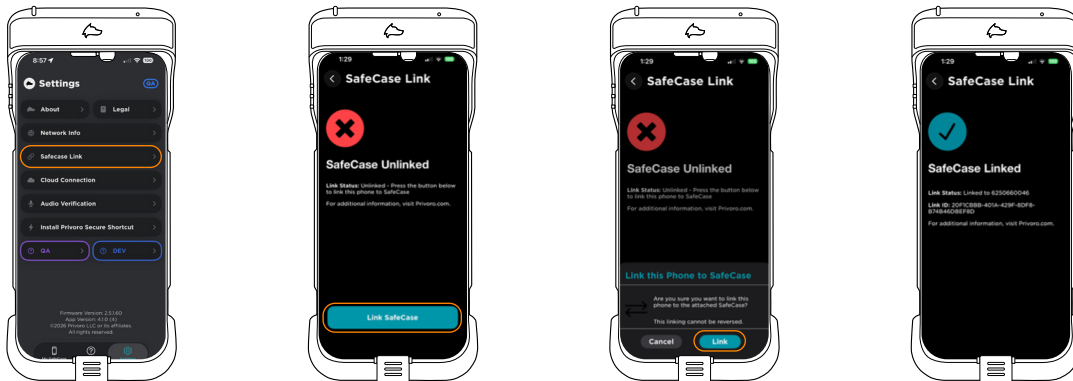

## Appendices A – C: Organizational Automations and Controls

SafeCase may use iOS shortcuts or system automations to support organizational security policies, such as enforcing radio settings when entering or exiting restricted areas. These automations are configured by your organization and typically require no ongoing user action after onboarding.

If setup or confirmation is required, it will be completed during training or guided by your administrator.

## Appendix A: Enable SafeCase Edge Locking Shortcut in The Privoro App

SafeCase Edge Locking requires installation of the Privoro Secure iOS Shortcut. This shortcut then runs automatically when the Edge Locking conditions are met in the SafeCase policy.

To install the Privoro Secure Shortcut:

1. In the Privoro App, go to **Settings**.
  2. Tap **Install Privoro Secure Shortcut**.
  3. An iOS share-sheet will appear.
  4. Select Shortcuts to open the Privoro Secure Shortcut.
  5. When prompted, tap **Add Shortcut** to complete installation
- Once installed, the shortcut runs automatically when triggered by SafeCase.



# Appendix B: Creating a Check-In Automation in iOS Shortcuts (Cellular Data Off)

## Setup iOS automation

### 1. Go to Shortcuts on iOS

Go to Automation Tab at the bottom of Shortcuts

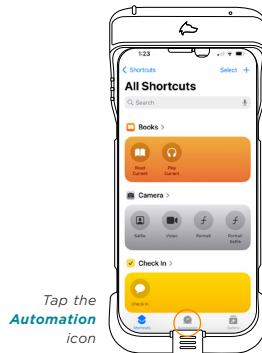

### 2. Select "New Automation" in either middle of screen or upper right-hand corner

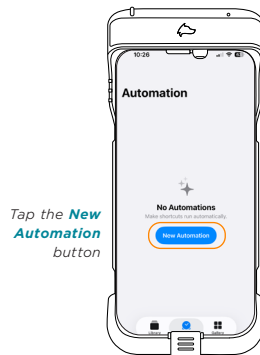

### 3 Scroll down and tap "Wi-Fi"

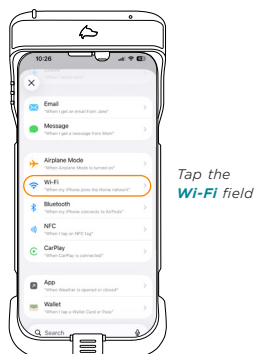

### 4. On "Network", tap and select "SafeCase" SSID

- Tap "Done" in upper right corner
- Select "Network Joined"
- Enable "Run After Connection Interruption" and select "Run Immediately" where a check mark will highlight the section
- Tap "Next"



### 5. Under "Get Started" tap "Set Cellular Data" tile



- Tap Cellular Data Off

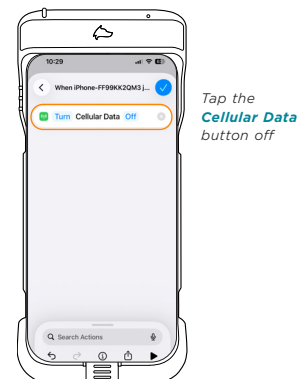

6. In the “Search Action” bar, type “Bluetooth”

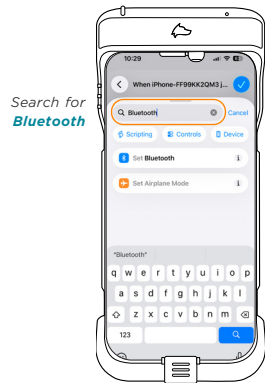

- Select “Set Bluetooth”
- Keep to “Bluetooth On”

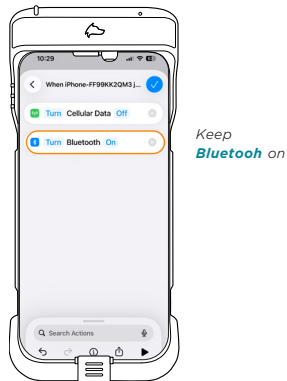

7. In the “Search Action”, type “Wait”

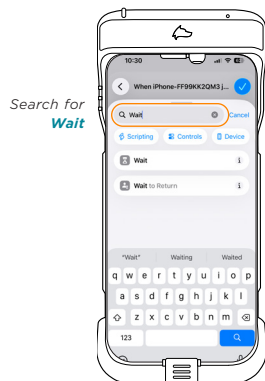

- Keep “Wait” at 1 second
- In the “Search Action”, type “Open App”

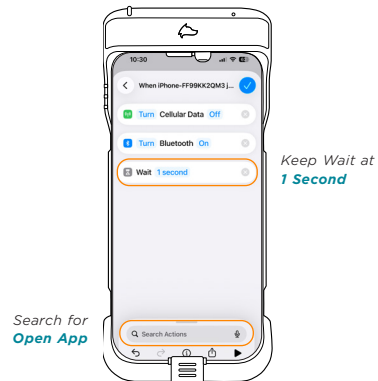

8. Hit “Open App”

- Tap “App” in the “Open App” section
- Search for Privoro

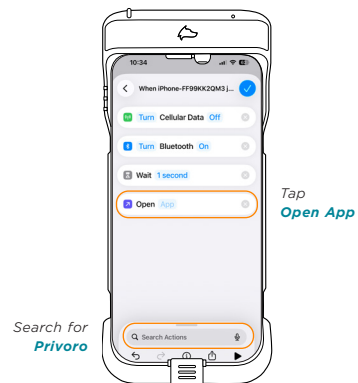

9. Tap “Privoro” app

- Tap “Done” in the upper right-hand corner
- The automation image should look like this:

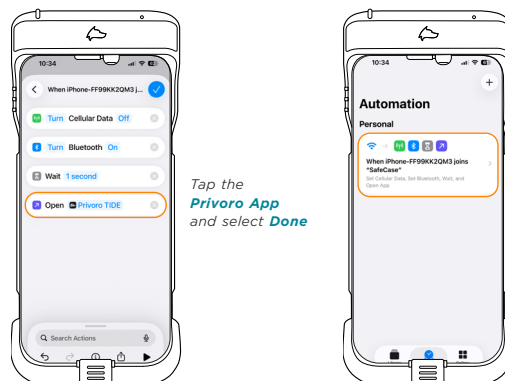



# Appendix C: Creating a Check-In Automation in iOS Shortcuts

## (Airplane Mode)

### 1. Open Shortcuts tap Automation

Then tap the New Automation button

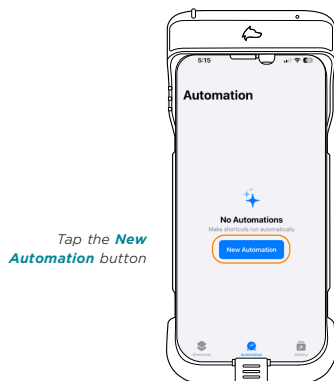
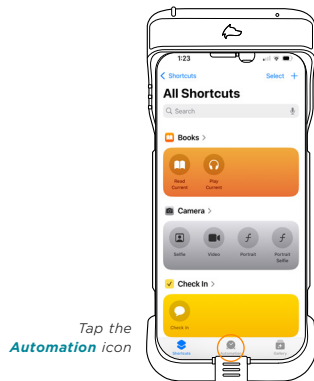

(If you have an existing automation, tap the + in the upper right)

### 2. Choose "Wi-Fi"

Scroll to Wi-Fi and select it.

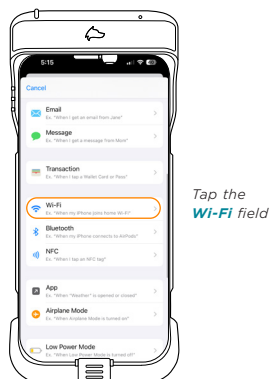

### 3. Select the Secure Spaces Wi-Fi

- Tap **Choose**, pick your Secure Spaces SSID, **Done**.
- Make sure **Network Joined** is selected.
- Turn **Run After Connection Interruption** ON.
- Select **Run Immediately**.
- Tap **Next**.

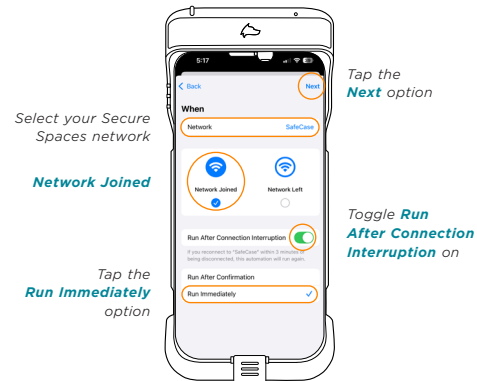

### 4. Select New Blank Automation



### 5. Add Action: Set Airplane Mode

Tap **Add Action**, search **Airplane Mode**, select **Set Airplane Mode**, set to **On**.



#### 6. Add Action: Turn Bluetooth On

Tap **Add Action**, search **Bluetooth**, **Set Bluetooth**, set to **On**.

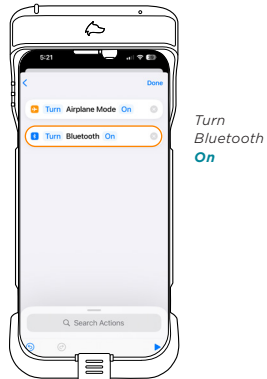

#### 7. Add Action: Turn Wi-Fi On

Tap **Add Action**, search **Wi-Fi**, **Set Wi-Fi**, set to **On**.

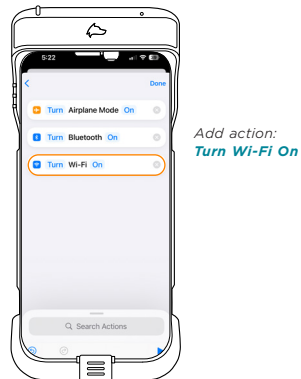

#### 8. Add Action: Open Privoro

Tap **Add Action**, search **Open App**, select **Privoro**.

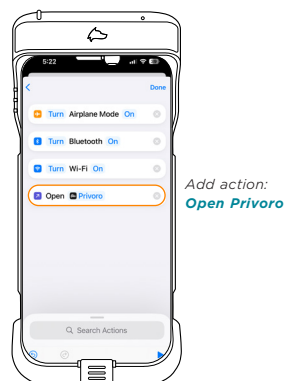

#### 9. Save the Automation

Tap **Done** in the top right.

Your automation will show the 4 steps:

- Airplane Mode On
- Bluetooth On
- Wi-Fi On
- Open App Privoro

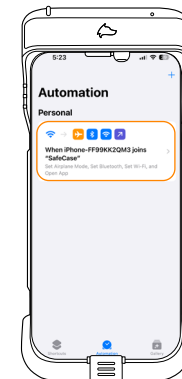
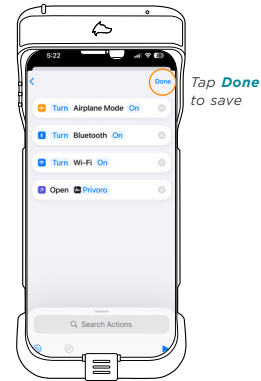

## Appendices D – H: Reference, Safety, and Compliance

The following appendices provide reference information, safety guidance, and regulatory disclosures. These sections are not required for the daily operation of SafeCase CRBN.

# Appendix D: Daily Charging Requirements and Approved Accessories

### Managing Power

#### Charge

SafeCase CRBN and iPhone are designed to be charged at the same time using a USB-C cable and a USB-C power adapter.

Because maintaining sufficient battery power is a policy requirement for use in restricted areas, we recommend charging both overnight to ensure adequate power for the next day.

A complete list of **Approved Charging Accessories** can be found at the bottom of this section.

#### Check Battery Level

##### Via the Privoro App

1. On the My SafeCase screen, view the percentage displayed in the **Case Battery Level** field.

##### Via SafeCase CRBN

1. Press the power button. The power LED will illuminate for four seconds in the color corresponding to the battery level.

#### Power On/Off

1. Press and hold the power button for three seconds.
2. A “power on” or “power off” audio alert will play and the power and Mode LEDs will blink white five times.

Color of power LED	Battery level
Green	41-100%
Amber	11-40%
Red	0-10%

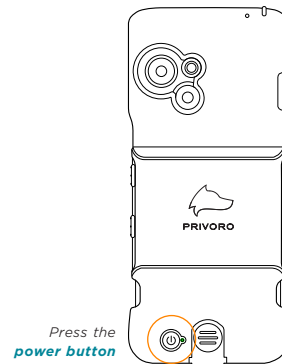

### Approved Charging Accessories

We recommend the following charging accessories for CRBN, to be used in conjunction with the Privoro-provided USB-C cable.

Type	Name	Model Number
Standard charger	Apple 20W USB-C Power Adapter	3MHJA3AM/A
Car charger	Belkin BoostCharge 30W USB-C Car Charger	CCA004btBK
Power bank, normal capacity	Anker Nano 30W 10,000mAh USB-C Power Bank	A1259H11
Power bank, high capacity	Anker Nano 30W 20,000mAh USB-C Power Bank	A1387H11-1

## Appendix E: Verifying Audio Masking

The Privoro app enables you to verify that CRBN audio masking is working as intended while in protected mode.

**To verify audio masking:**

1. In the Privoro app, go to **Settings** and tap **Audio Verification**.

Tap the **Audio Verification** icon

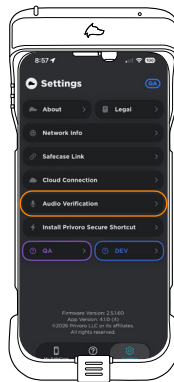

2. On the Audio Verification screen, tap the option for the microphone you'd like to test (**Back Mic**, **Front Mic** or **Bottom Mic**), if not already selected.
3. Tap the **Start Recording** button.

Tap the **Start Recording** button



4. While recording, you can introduce additional noise into your environment, perhaps by speaking or playing music. You can also switch between protected mode and unprotected mode to highlight the difference between the two modes.
5. When finished recording, tap the **Stop Recording** button.

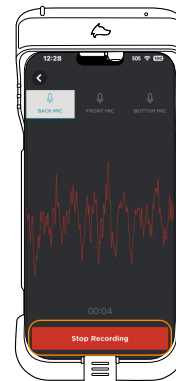

Tap the **Stop Recording** button

6. Tap the **playback** icon to listen to the recording.

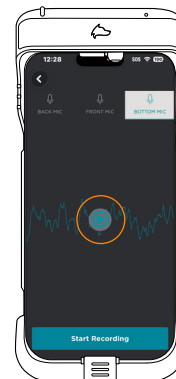

Tap the **playback** icon

7. While listening, verify that the audio masking noise drowns out all sounds. You can repeat the above steps for the other two microphones.

## Appendix F: Safety and handling

**WARNING: Follow these safety instructions to avoid fire, electric shock, injury, damage to SafeCase CRBN or other property.**

### Size and weight

- Height: 170 mm
- Width: 79 mm
- Depth: 23 mm
- Weight: 142 g

### Connectivity

- Bluetooth
- NFC (tag only)

### Audio

- Digital signal processor for optimum audio quality and secure voice masking
- Masks speech intelligibility up to voice level of 90 dBA<sup>1</sup>
- Masks speech presence up to voice level of 80 dBA<sup>1</sup>

### Battery and battery life

- Protected mode: Up to 20 hours
- Charge time: Up to 80% power level in two hours<sup>2</sup>

### Electrical ratings

- 3.8V, 2,000 mAh lithium-ion battery
- Maximum input current: 1200mA
- Rated voltage: 5VDC

### Environmental requirements

- Operating temperature: -4° and 113° F (-20° and 45° C)
- Relative humidity: Up to 95%
- Operating altitude: Up to 10,000 feet (3000 m)

<sup>1</sup> Tested one meter from audio source.

<sup>2</sup> Tested with 1-Amp charging supply (DCP) on the battery at 3% of its full capacity.

## Appendix G: Recycling

Privoro has partnered with Call2Recycle for your device and battery recycling needs (within the United States and Canada). To find a recycling location near you, go to [www.call2recycle.org/locator/](http://www.call2recycle.org/locator/) and enter your zip code.



# Appendix H: Regulatory information

## FCC Compliance Statement

This equipment has been tested and found to comply with the limits for a Class B digital device, pursuant to Part 15 of the FCC Rules. These limits are designed to provide reasonable protection against harmful interference in a residential installation. This equipment generates, uses and can radiate radio frequency energy and, if not installed and used in accordance with the instructions, may cause harmful interference to radio communications. However, there is no guarantee that interference will not occur in a particular installation. If this equipment does cause harmful interference to radio or television reception, which can be determined by turning the equipment off and on, the user is encouraged to try to correct the interference by one of the following measures:

- Reorient or relocate the receiving antenna.
- Increase the separation between the equipment and receiver.
- Connect the equipment into an outlet on a circuit different from that to which the receiver is connected.
- Consult the dealer or an experienced radio/TV technician for help.

Changes or modifications not expressly approved by the party responsible for compliance could void the user's authority to operate the equipment.

This device complies with part 15 of the FCC Rules. Operation is subject to the following two conditions:

- (1) This device may not cause harmful interference, and
- (2) this device must accept any interference received, including interference that may cause undesired operation.

## Canadian Regulatory Statement

This device complies with Industry Canada's licence-exempt RSSs. Operation is subject to the following two conditions:

- (1) This device may not cause interference; and
- (2) This device must accept any interference, including interference that may cause undesired operation of the device.

Le présent appareil est conforme aux CNR d'Industrie Canada applicables aux appareils radio exempts de licence. L'exploitation est autorisée aux deux conditions suivantes:

- (1) l'appareil ne doit pas produire de brouillage;
- (2) l'appareil doit accepter tout brouillage radioélectrique subi, même si le brouillage est susceptible d'en compromettre le fonctionnement.

## Specific Absorption Rate (SAR) Certification Information

This device is a radio transmitter and receiver. It is designed and manufactured not to exceed the exposure limits for Radio Frequency (RF) energy set by the Federal Communications Commission (FCC) of the U.S. Government.

These FCC RF exposure limits are derived from the recommendations of two expert organizations: the National Council on Radiation Protection and Measurement (NCRP) and the Institute of Electrical and Electronics Engineers (IEEE). In both cases, the recommendations were developed by scientific and engineering experts drawn from industry, government, and academia after extensive reviews of the scientific literature related to the biological effects of RF energy.

The RF exposure limit set by the FCC for wireless mobile devices employs a unit of measurement known as the Specific Absorption Rate (SAR). The SAR is a measure of the rate of absorption of RF energy by the human body expressed in units of watts per kilogram (W/kg). The FCC SAR limit incorporates a substantial margin of safety to give additional protection to the public and to account for any variations in measurements.

For more information about SAR, visit:

- [fcc.gov/general/radio-frequency-safety-0](https://fcc.gov/general/radio-frequency-safety-0)
- [fcc.gov/encyclopedia/specific-absorption-rate-sar-cellular-telephones](https://fcc.gov/encyclopedia/specific-absorption-rate-sar-cellular-telephones)



## EU Compliance Statement

Privoro hereby declares that this wireless device is in compliance with the essential requirements and other relevant provisions of the Radio Equipment Directive 2014/53/EU, as applicable. A copy of the EU Declaration of Conformity is available at [privoro.com/legal](https://privoro.com/legal). Legal, regulatory and compliance documentation are also available to view at the same link.



## European Union—Disposal Information

The Wheeled Bin symbol means that according to local laws and regulations your product and/or its battery shall be disposed of separately from household waste. When this product reaches its end of life, take it to a collection point designated by local authorities. The separate collection and recycling of your product and/or its battery at the time of disposal will help conserve natural resources and ensure that it is recycled in a manner that protects human health and the environment.